

Wireless Loadshackle

Product information



Wireless loadshackle with low headroom and a load-centering bobbin.

Battery type/life: Loadcell 4 x AA Alkaline/Load cell 1200 hours continuous.

Accuracy: $\pm 1\%$ of applied load.

Frequency: 2.4 GHz.

System range: 700 m.

Data rate: 3 updates per second.

Protection: IP67.

Temperature range: -10°C up to $+50^{\circ}\text{C}$.

Note: Safety factor when used with a load bobbin.

Safety factor: 5:1

Wireless Loadshackle

Blueprint

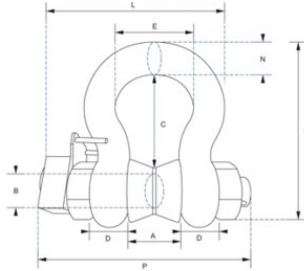

Technical data

Part code	Code	WLL ton	Resolution T	A mm	ØB mm	C mm	D mm	Emm mm	Hmm mm	L mm	Nmm mm	Pmm mm	Weight kg	Delivery time
423500330160	WLS3,25T	3.25	5	26.9	19.1	56.9	16	42.9	106	127.1	17.5	143	2.8	10
423500650160	WLS6,5T	6.5	5	36.6	25.4	79.7	22.4	58	148	156.5	24.6	173	3.2	10
423501200160	WLS12T	12	10	51.5	35.1	113	31.8	82.5	210	196	35.1	218	8	10
423502500160	WLS25T	25	20	73	51	170	44.5	127	313	281	57	293	18	10
423505500160	WLS55T	55	50	82.5	57	189.5	51	164	348	306	61	317	25	10
423508500160	WLS85T	85	50	105	70	253	66.5	184	453	368	79	394	45	10
423512000160	WLS120T	120	100	127	82.5	319.5	76	200	546	408	92	441	85	10
423520000160	WLS200T	200	200	180	125	483	120	290	810	580	120	565	254	10
423530000160	WLS300T	300	500	205	150	576	130	305	950	615	130	615	374	10
423540000160	WLS400T	400	500	230	175	650	165	325	1,100	705	165	711	614	10