

Sling Shackle P-6033

Product information



Bow shackles with safety bolt.

Certification: This product can be supplied with a works certificate, 3.1 material certificate, manufacturer test certificate, EC Declaration of Conformity and all shackles from 75 t and up are supplied with a Lloyd's Register of Shipping Certificate on proof load. For shackles 75 t and up an MPI and/or US inspection certificate can be supplied on request.

This shackle can also be delivered with fixed nut (an extra AISI 316 securing bolt is drilled through both the nut and shackle pin. This securing bolt is fastened with two sets of Nord-Lock® washers and a securing nut. These washers lock when subjected to movement and keep the nut safely in position).

Material: Bow and pin alloy steel, quenched and tempered

Marking: CE-marked

Temperature range: -20°C up to +200°C

Finish: Shackle bow painted silver, pin painted green

Note: for details on dimensions and tolerances please consult our CAD drawings, these are available on request

Safety factor: 5:1

Grade: 8

Sling Shackle P-6033

Blueprint

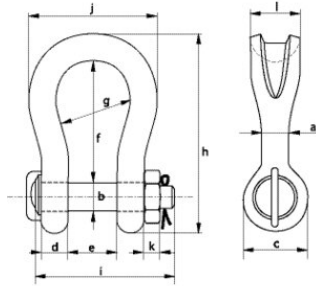

Technical data

Part code	WLL ton	a mm	b mm	c mm	d mm	e mm	f mm	g mm	h mm	i mm	j mm	k mm	l mm	Weight kg	Delivery time
420100701010	7	22	22	46	19	32	96	64	153	115	110	19	41	1.97	10
420101251010	12.5	28	28	61	25	44	120	82	197	151	146	24	54	4.27	10
420101801010	18	35	35	69	30	54	148	102	239	171	180	29	64	6.85	10
420103001010	30	40	42	90	35	69	165	126	279	207	200	34	79	12.5	10
420104001010	40	55	51	109	45	84	199	140	331	252	235	38	97	20.3	10
420105501010	55	60	57	115	55	90	240	160	389	294	270	45	100	30.4	2
420107501010	75	68	70	126	54	110	290	185	473	317	331	40	120	49	10
420112501010	125	85	80	156	85	137	366	220	583	413	390	40	150	95	10
420115001010	150	94	95	181	89	147	391	253	648	445	449	50	170	125	10
420120001010	200	110	105	201	100	158	481	280	759	480	500	50	205	190	10
420125001010	250	126	120	229	110	179	542	300	860	535	552	60	240	264	10
420130001010	300	136	134	246	134	195	601	350	946	590	620	70	265	360	10
420140001010	400	160	160	295	145	231	576	370	995	687	710	80	320	583	10
420150001010	500	170	180	330	160	263	681	450	1,161	762	850	90	340	862	10
420160001010	600	190	200	360	170	289	741	490	1,264	827	930	100	370	1,134	10