

Stainless Eye Terminal

Product information



Eye terminals for pressing or swaging onto stainless steel wire rope. They are mainly used as an attachment to rigging screws or forks.



Material: Stainless steel AISI 316.

Marking: logo, wire size and swage depth.

Temperature range: -50°C to +100°C and briefly up to +200°C

Finish: High polished.

Stainless Eye Terminal

Blueprint

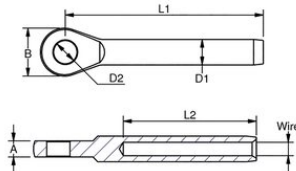

Technical data

| Part code | Rope Ø range mm | MBL ton | A mm | B mm | D1mm mm | D2mm mm | L1mm mm | L2mm mm | Weight kg/100pc | Delivery time |
|-------------|-----------------|---------|------|------|---------|---------|---------|---------|-----------------|---------------|
| 1207190002 | 2 | 1.2 | 3 | 12 | 5,5 | 5,5 | 41 | 24 | 0.9 | 10 |
| 1207190025 | 2.5 | 1 | 3 | 12 | 5,5 | 5,5 | 44 | 27 | 0.8 | 10 |
| 1207190003 | 3 | 1.3 | 4 | 14 | 6,35 | 6,5 | 60 | 38 | 1.3 | 10 |
| 1207190004 | 4 | 1.7 | 5 | 17 | 7,5 | 8,5 | 67 | 45 | 2.3 | 2 |
| 1207190005 | 5 | 2.4 | 6 | 21 | 9,0 | 10,5 | 79 | 51 | 3.9 | 2 |
| 1207190006 | 6 | 5.5 | 8 | 25 | 12,58 | 13,0 | 94 | 64 | 8.7 | 2 |
| 1207190006X | 6 | 5.5 | 10 | 28 | 12,58 | 13,2 | 105 | 64 | 13.2 | 10 |
| 1207190007 | 7 | 6.8 | 9 | 27 | 14,2 | 13,0 | 104 | 70 | 11.5 | 10 |
| 1207190007X | 7 | 6.8 | 10 | 28 | 14,2 | 13,2 | 110 | 70 | 13.5 | 10 |
| 1207190008 | 8 | 8 | 10 | 30 | 16,0 | 14,5 | 124 | 83 | 17 | 2 |
| 1207190008X | 8 | 8 | 12 | 36 | 16,0 | 16,5 | 141 | 83 | 23.5 | 10 |
| 1207190010 | 10 | 9.7 | 11 | 35 | 17,8 | 16,3 | 137 | 89 | 25 | 2 |
| 1207190010X | 10 | 9.7 | 16 | 40 | 17,8 | 19,5 | 165 | 100 | 38 | 10 |
| 1207190012X | 12 | 14.2 | 15 | 42 | 21,4 | 19,3 | 178 | 120 | 41 | 10 |
| 1207190012 | 12 | 11.4 | 15 | 40 | 20,0 | 19,3 | 156 | 105 | 41.5 | 2 |
| 1207190014 | 14 | 15.9 | 18 | 47 | 25,0 | 23,0 | 206 | 140 | 75.6 | 10 |
| 1207190016 | 16 | 19 | 20 | 53 | 28,0 | 26 | 232 | 160 | 102 | 10 |
| 1207190016 | 19 | 31 | 25 | 65 | 34,5 | 28,5 | 302 | 200 | 209 | 10 |
| 1207190022 | 22 | 42 | 30 | 70 | 40,4 | 33,0 | 348 | 230 | 314 | 10 |
| 1207190026 | 26 | 53 | 30 | 77 | 46,0 | 36,0 | 400 | 280 | 425 | 10 |