

## Swageless Terminal with Fork

### Product information



Swageless stainless fork / jaw terminal for safe, reliable and machine free self assembly.



**Material:** Stainless steel AISI 316.

**Temperature range:** -50°C to +100°C and briefly up to +200°C

**Finish:** High polished.

**Warning:** Read assembly instructions before use!

## Swageless Terminal with Fork

### Blueprint

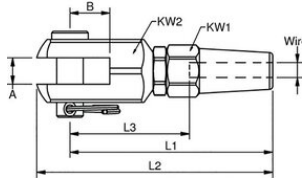

### Technical data

Part code	Rope Ø range mm	Pin diameter mm	MBL ton	Wire Ø inch	A mm	B mm	L1mm mm	L2mm mm	L3 mm mm	L4 mm mm	KW1 mm	KW2 mm	Weight kg/100pc	Delivery time
1207840603	3	6	0.75	1/8"	6	11	55	63	29	8	12	14	5.5	10
1207841047	4	8	1.5	5/32"	8	12	62	73	35	8	14	19	7.3	10
1207841005	5	10	2.18	-	10	15	72	83	42	10	16	22	15	10
1207841206	6	12	3.7	1/4"	12	18	82	95	48	12	19	27	23	10
1207841207	7	12	4.7	9/32"	12	18	102	115	55	13	21	29	29	10
1207841408	8	14	5.6	5/16"	14	21	103	118	58	14	24	30	38	10
1207841610	10	16	8.3	-	16	24	117	135	70	16	27	36	63	10
1207841912	12	19	12	-	18	26	142	162	75	16	32	42	97	10
1207842214	14	22	14	-	21	30	162	191	88	19	36	46	135	10
1207842516	16	25	23	-	23	35	184	217	102	22	41	55	215	10