

Screw Pin Sling Shackle Crosby S-253

Product information



The Crosby S-253 top sling is designed to connect slings to steel fittings.

Meets or exceeds all requirements of ASME B30.26 including identification, ductility, design factor, proof load and temperature requirements. Importantly, these shackles meet other critical performance requirements including fatigue life, impact properties and material traceability, not addressed by ASME B30.26.

Material: All alloy construction.

Marking: According to standard, CE-marked, Each shackle has a Product Identification Code (PIC) for material traceability along with a Working Load Limit and the name Crosby forged into it.

Standard: EN 13889

Safety factor: 5:1

Screw Pin Sling Shackle Crosby S-253

Blueprint

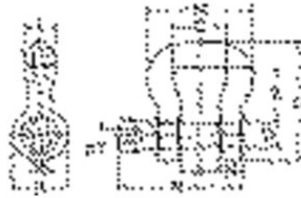

Technical data

Part code	WLL ton	Eye width mm	A mm	B mm	C mm	D mm	Emm mm	Gmm mm	Kmm mm	L mm	Mmm mm	Nmm mm	Pmm mm	Rmm mm	Weight kg	Delivery time
420100330210	3.25	25	22.4	15.7	35.1	19.1	38.1	86	38.1	19.1	68.5	82	11.2	25.4	0.64	10
420100650210	6.5	35	31.8	19.1	44.5	22.4	47.8	105	46	25.4	86	102	12.7	30.2	1	10
420100880210	8.75	50	35.1	22.4	57	25.4	71.5	140	53	28.4	106	114	12.7	36.6	1.72	10
420101250210	12.5	75	41.1	28.4	82.6	31.8	77.5	161	66.5	35.1	143	142	15.7	46	3.31	10
420102050210	20.5	100	54	35.1	114	38.1	133	240	79	44.5	191	175	19.1	54	6.89	10
420103500210	35	125	63.5	44.5	140	51	161	292	106	57	233	220	25.4	73	14	10
420105000210	50	150	76	54	165	57	196	349	121	70	279	260	31	81	23.6	10