

## Sheet Metal Plate Hook Pewag BWW

### Product information



BWW Sheet metal plate hooks are designed for the assembling of chain slings. They serve for loading and transporting sheet metal stacks and plates. For lifting sheet metal stacks and boards.

**Recommended angle of inclination of the sling:**  $\beta$  15-30°.

Use min. 3-leg chain sling.

**Material:** High duty grade 10.

**Marking:** According to standard, CE-marked, Pewag or PW, winner or 10, H16, batch code and type.

**Temperature range:** -40°C up to +380°C.

**Finish:** Orange powder coated.

**Standard:** EN 1677-1

**Note:** When lifting with BWW it is very important that the load is bump-free and the transport is done without vibrations. It is very important that the specified slope angle is maintained. Lifting clamps will be a safer alternative

**Safety factor:** 4:1

**Grade:** 10

## Sheet Metal Plate Hook Pewag BWW

### Blueprint

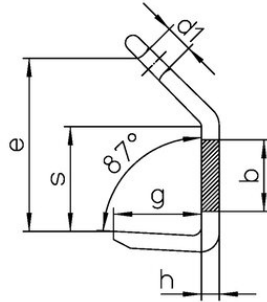

### Technical data

Part code	Code	WLL ton	b mm mm	d1 mm mm	e mm mm	g mm mm	h mm mm	s mm mm	Weight kg	Delivery time
402300250600	BWW 7/8	2.5	50	28	131	55	15	80	1.5	10
402300400600	BWW 10	4	70	36	170	65	20	100	2.8	10
402300670600	BWW 13	6.7	80	40	209	90	25	130	5.3	10
402301000600	BWW 16	10	100	50	263	110	30	160	10.5	10
402301600600	BWW 19/20	16	120	60	306	130	40	185	17.5	10
402301900600	BWW 22	19	140	75	368	150	50	220	30.5	10